

MARQUIS STREET

RESERVOIR STREET

ANZAC PARADE

LIONS PARK

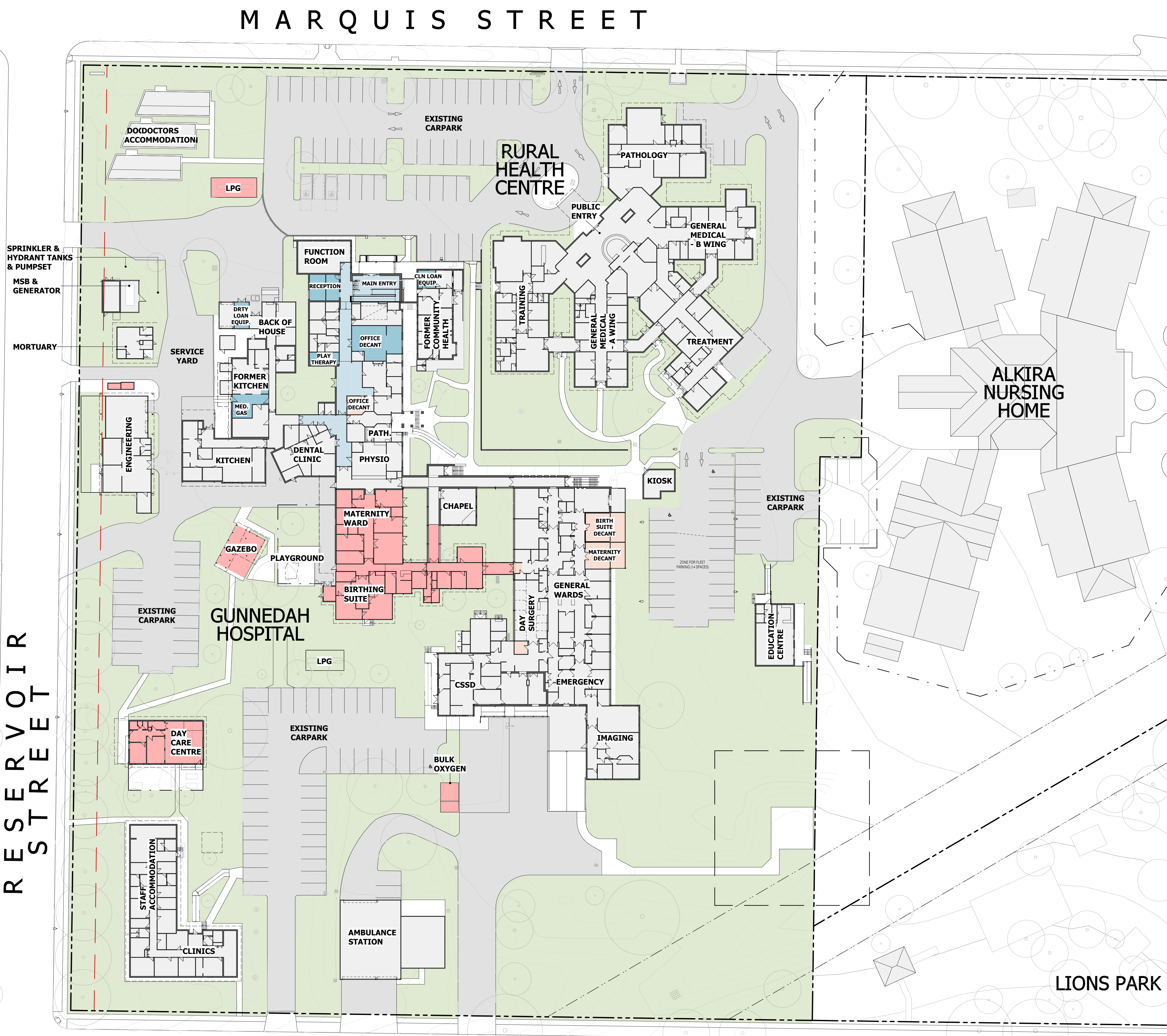

Notes

The information contained in this document is copyright and may not be used or reproduced for any other project or purpose. Verify all dimensions and levels on site and report any discrepancies to dwp for direction prior to the commencement of work. Drawings are to be read in conjunction with all other contract documents.

Use figured dimensions only. Do not scale from drawings. dwp cannot guarantee the accuracy of content and format for copies of drawings issued electronically. The completion of the Issue Details Checked and Authorised section is confirmation of the status of the drawing. The drawing shall not be used for construction unless endorsed 'For Construction' and authorised for issue.

© dwp Australia Pty Ltd  
Registered Business Name dwp Australia ABN 37 169 328 018  
Nominated Architect Angus Rose NSW ARB 8341 & 8341

© Copyright 2011 dwp.  
ALL RIGHTS RESERVED.  
Reproduction prohibited unless authorised in writing by dwp.

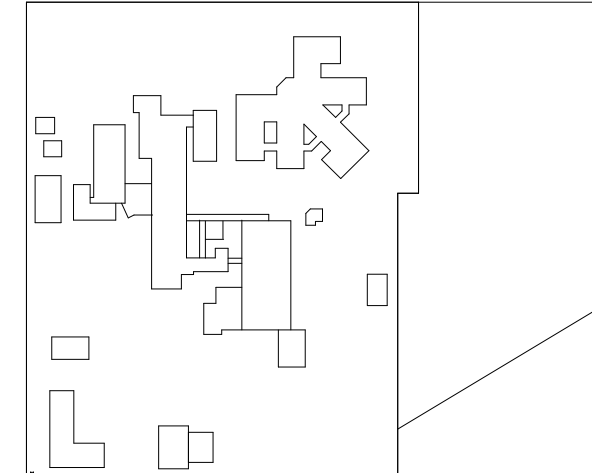

- SITE LEGEND**
- TURFED AREA
  - MASS PLANTING OF NATIVE GRASSES
  - MASS PLANTING AREA
  - PAVING TYPE 1
  - PAVING TYPE 2
  - NEW ROADWAYS / PARKING
  - EXISTING ROADWAYS / PARKING

- DEPARTMENT LEGEND**
- EXISTING
  - DECANT (TEMPORARY)
  - DECANT (PERMANENT)
  - DEMOLITION
  - REFURBISHMENT

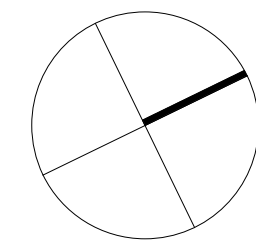

**DESIGN DEVELOPMENT**  
NOT TO BE USED DURING CONSTRUCTION

A	ISSUED TO COUNCIL	19.06.2023
Issue	Description	Date
Architect/ Designer	dwp	www.dwp.com

Client  
NSW HEALTH INFRASTRUCTURE

Project  
GUNNEDAH HOSPITAL  
REDEVELOPMENT  
Location  
MARQUIS STREET, GUNNEDAH,  
NSW 2380

Project Number  
**21-0218**

Drawing  
**SITE EARLY WORKS &  
DECANT DIAGRAM**

Scale (A1)  
As indicated  
Date Printed  
19/06/2023 4:02:41 PM  
Drawing Number  
AR-00-AA0010  
Issue  
A





MARQUIS STREET

RESERVOIR STREET

ANZAC PARADE

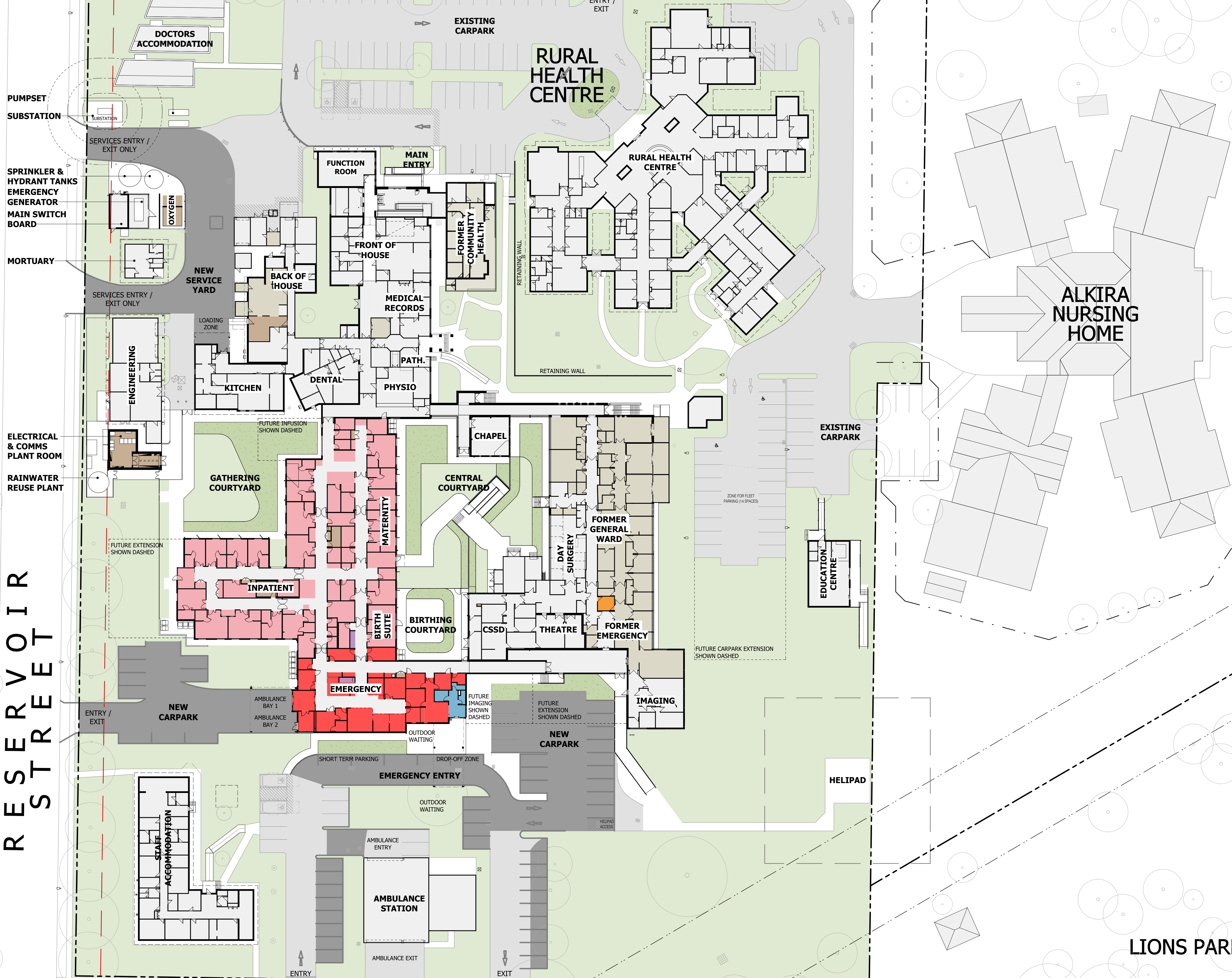

Notes  
The information contained in this document is copyright and may not be used or reproduced for any other project or purpose. Verify all dimensions and levels on site and report any discrepancies to dwp for direction prior to the commencement of work. Drawings are to be read in conjunction with all other contract documents.  
Use figured dimensions only. Do not scale from drawings. dwp cannot guarantee the accuracy of content and format for copies of drawings issued electronically. The completion of the Issue Details Checked and Authorised section is confirmation of the status of the drawing. The drawing shall not be used for construction unless endorsed 'For Construction' and authorised for issue.  
© dwp Australia Pty Ltd  
Registered Business Name dwp Australia ABN 37 169 328 018  
Nominated Architect Angus Rose NSW ARB 8341 & 1.  
© Copyright 2011 dwp.  
ALL RIGHTS RESERVED.  
Reproduction prohibited unless authorised in writing by dwp.

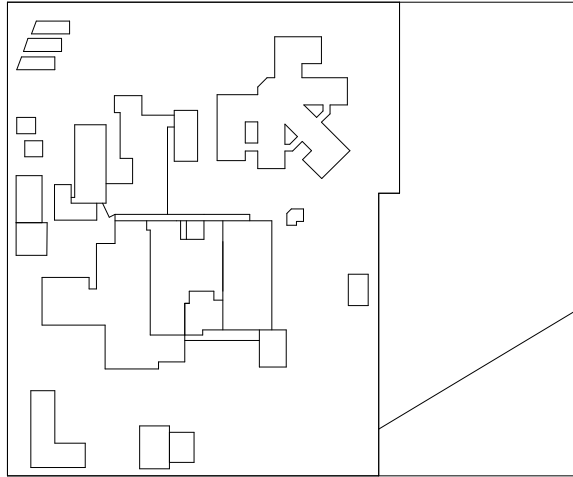

- SITE LEGEND**
- TURFED AREA
  - MASS PLANTING OF NATIVE GRASSES
  - MASS PLANTING AREA
  - PAVING TYPE 1
  - PAVING TYPE 2
  - NEW ROADWAYS / PARKING
  - EXISTING ROADWAYS / PARKING

- DEPARTMENT LEGEND**
- EXISTING
  - EMERGENCY DEPARTMENT
  - FRONT OF HOUSE
  - INPATIENT, MATERNITY & BIRTHING
  - PLANT
  - THEATRES & DAY SURGERY
  - VACANT

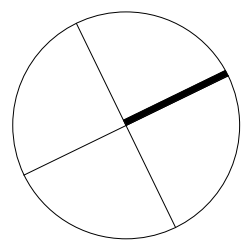

**DESIGN DEVELOPMENT**  
NOT TO BE USED DURING CONSTRUCTION

A	ISSUED TO COUNCIL	19.06.2023
Issue	Description	Date
Architect/ Designer	dwp	
www.dwp.com		

Client  
NSW HEALTH INFRASTRUCTURE

Project  
GUNNEDAH HOSPITAL  
REDEVELOPMENT  
Location  
MARQUIS STREET, GUNNEDAH,  
NSW 2380

Project Number  
**21-0218**  
Drawing  
**SITE MAIN WORKS  
DIAGRAM**

Scale (A1)  
As indicated  
Date Printed  
19/06/2023 4:02:52 PM  
Drawing Number  
AR-00-AA0011  
Issue  
A

